

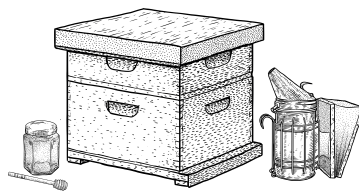

2022 FALL
CONFERENCE

SEPTEMBER 22 - 24
GAINESVILLE, GA



THANK YOU TO OUR GENEROUS SPONSORS



KEYNOTE SPEAKERS



DR. MOHAMMED ALBURAKI, PH.D., is a Research Scientist at the U.S. Department of Agriculture Bee Research Laboratory in Beltsville, MD. He is a longtime beekeeper and has practiced beekeeping in many countries. He obtained his Ph.D. in honey bee genetics and behavior from the University of Pierre and Marie Curie, Paris, France. Dr. Alburaki conducted extensive studies on honey bee diversity, evolution and functional genomics during his Post-doctoral Researcher and investigated the effect of pesticides on honey bee health in Canada and the USA.

- *Newly Designed RFID Unit To Track Queen Behavior*
- *Genetic Diversity Of The Us Honey Bee Populations*



DR. LEWIS BARTLETT, PH.D., is an infectious disease biologist, entomologist, and evolutionary ecologist at the University of Georgia's Center for the Ecology of Infectious Diseases. He uses field studies, laboratory experiments, and computer simulations to understand how changes in beekeeping are affecting bee diseases in both the short and long term.

- *The Science Behind Linking Queen Health, Pesticide Exposure, And Nutrition*
- *Separating The Good, The Bad, And The Ugly: Understanding The Differences Between Chemical Exposures To Our Bees*



MELANIE KIRBY is an Interdisciplinary, integrating apiculture, agroecology, and communication to support the industry as a queen breeder, consilience researcher, and writer. She is an active participant in the American Association of Professional Apiculturists, COLOSS, the Rocky Mountain Farmers Union, National Young Farmers Coalition, Slow Bees, and serves on the boards of the New Mexico Beekeepers Association, Western Apiculturist Society of North America, and the American Beekeeping Federation. She is the founder of the Adaptive Bee Breeders Alliance and has been keeping bees professionally for 25 years.

- *Bees As Seeds – The origins of Apis m. and what that means for today's American bee breeding efforts*
- *It Takes A Community – The importance of place, power, and purpose in pollinator conservation*



DR. SAMUEL RAMSEY, PH.D., is the Endowed Professor of Entomology at Colorado University-Boulder's BioFrontiers Institute, where he seeks to apply his fascination with invertebrates to understanding and preserving the ecosystems that they make possible. His research on honey bee health decline has taken him around the globe in search of a better understanding of how pollinator pandemics start and how they can be stopped. His nonprofit, The Ramsey Research Foundation, works to remove barriers that slow the progress of and decrease access to science by developing novel pathways for scientific funding and by removing paywalls that keep the public from engaging with published scientific work.

- *Varroa Destructor Feeds on Bee Blood and Two Other Alternative Facts*
- *Biodiversity & Diversity in Bio: What's the Point?*



MARINA MARCHESE is a beekeeper, author and a member of the Italian National Register of Experts in the Sensory Analysis of Honey. She is the coauthor of *The Honey Connoisseur* (with Kim Flottum), *Honey for Dummies* (with Howland Blackiston) and her beekeeping memoir *Honeybee Lessons from an Accidental Beekeeper*. In 2011, Marina established The American Honey Tasting Society as the leading resource for honey sensory education in the United States.

- *How to Taste and Evaluate Honey: Matching Flowers to Flavors – This special two-hour workshop is a complete sensory experience in honey tasting! Learn how flowers and terroir affect honey's sensory characteristics.* (This seminar will be offered twice. Each session is **limited to 25 participants**. There is an additional fee of \$15 to take this workshop which is payable when you register for the conference.)

BOARD OF DIRECTORS

2022 OFFICERS

President

Gina Gallucci

Vice President

Derrick Fowler

Secretary

Georgia Zumwalt

Treasurer

Luke Ellerman

Newsletter Editors

Kathy Bourn & Peter Helfrich

Past President

Linda Tillman

SCHEDULE

THURSDAY, SEPTEMBER 22ND

3:00 - 4:30	Honey Show entries accepted	Lanier Room
4:30	GBA Board of Directors meeting	
6:00	Dinner on your own	

FRIDAY, SEPTEMBER 23RD

7:15-9:00	Honey Show entries accepted	Lanier Room
8:45	Opening remarks – Gina Gallucci, GBA president	
9:00	KEYNOTE: Dr. Mohamed Alburaki – <i>Newly Designed RFID Unit To Track Queen Behavior</i>	
9:45	KEYNOTE: Dr. Lewis Barlett – <i>The Science Behind Linking Queen Health, Pesticide Exposure, And Nutrition.</i>	
10:30	Break to visit vendors and walk to breakout	
11:00	Breakout A (see listings on back page)	see back page
12:00	Lunch	
1:00	Announcements and door prizes	
1:15	KEYNOTE: Dr. Lewis Barlett – <i>Separating The Good, The Bad, And The Ugly: Understanding The Differences Between Chemical Exposures To Our Bees</i>	
2:15	Break to visit vendors	
2:45	Breakout B (repeat of morning sessions)	see back page
3:30	Break / Visit vendors	
4:00	KEYNOTE: Melanie Kirby – <i>Following The Origins Of Apis m. And What That Means For Today's American Bee Breeding Efforts</i>	
4:45	Visit vendors	
5:30	Beer & Wine	
5:45	Dinner (pre register)	
6:00	Dinner Speaker Bobby Chaisson – <i>What Bees Have Taught Me</i> (After the speaker, announcements will be made for Beekeeper of the Year and the Honey Show awards.)	

SATURDAY, SEPTEMBER 24TH

7:30	President's Breakfast	
8:15 - 11:00	8:15-11:00 Vote in GBA elections	
8:30	GBA Business Meeting	
9:15	KEYNOTE: Jonathan Hayes – <i>Using GBA's Membership Software</i>	
9:45	KEYNOTE: Dr. Samuel Ramsey – <i>Varroa destructor Feeds on Bee Blood and Two Other Alternative Facts</i>	
9:45- 11:45	HONEY SOMMELIER SEMINAR: Marina Marchese (Session repeats at 1:00 pm) *Additional fee and pre-registration required.	William Few
10:45	Announcements and door prizes	
11:00	Visit our vendors	
11:15	Breakout C (see listings on back page)	see back page
12:00	Lunch	
12:45	Announcement of election results	
1:00	KEYNOTE: Dr. Melanie Kirby – <i>The importance of place, power, and purpose in pollinator conservation.</i>	
1:00-3:00	HONEY SOMMELIER SEMINAR: Marina Marchese *Additional fee and pre-registration required.	William Few
1:45	KEYNOTE: Dr. Mohamed Alburaki – <i>Genetic Diversity Of The Us Honey Bee Populations</i>	
2:30	Final vendor break	
3:00	Breakout D (repeat morning sessions)	see back page
3:45	Ice Cream break	
4:00	KEYNOTE: Dr. Samuel Ramsey – <i>Biodiversity & Diversity in Bio: What's the Point?</i>	
4:45	Raffle drawings	
5:00	Conference concludes	

RAMSEY CONFERENCE CENTER

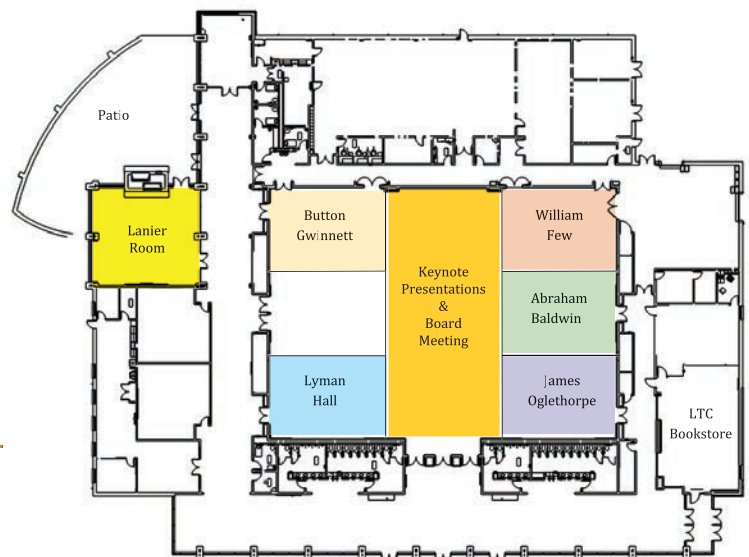

DIRECTORS

Webmaster
Jonathan Hayes

Bobby Chaisson
Kelley Campbell /
Mike Conner
(co-directors)

Brutz English
Monica Sheppard
Karen Palmer

Emily Heath

Ex-Officio Director
Jennifer Berry

BREAKOUT SESSIONS

FRIDAY BREAKOUT SESSIONS A & B *(Sessions Repeat)*

LOCATION



THE "WHYS" OF FALL MANAGEMENT – *Why are we still losing so many of our bees over the winter? Knowing a little more about what's going on in the hive as the colony transitions from summer bees to fall and winter bees can help.*

BILL DUNN began keeping bees in the "golden age" of beekeeping – before mites, some 35 years ago, when his father got a few hives. As an adult, the bee bug bit him hard and he remembers checking his first hive sometimes two to three times per day. He is the only charter member left in the Forsyth Beekeepers Club, which will be celebrating its 25-year anniversary in 2023.

LYMAN HALL



HOW AND WHY TO ENCOURAGE PROPOLIS COLLECTION – *Propolis is good for you AND your bees! Learn what it is, what it does, and how to help your bees collect and use more of it.*

CINDY HODGES is a Georgia Master Craftsman Beekeeper and EAS Master Beekeeper. She and her husband own and operate Hodges Honey apiaries located in Dunwoody and various locations around North Georgia. Cindy is a Senior Welsh Honey Judge and founder of the Dunwoody Beekeepers Club. In 2012, she received GBA's Beekeeper of the Year award.

JAMES OGLETHORPE



HOW TO MAKE MAGNETIC HIVE TOOL HOLDERS – *A step-by-step class on how to make leather magnetic hive tool holders to clip on your belt or pocket. Participants will see the products and simple tools used, as well as some examples from plain to ornate leather work.*

DAVID HOLLOMON is a Georgia Master Beekeeper. He volunteers at Arrendale State Prison's beekeeping program. He is an active member of the Tri-county Bee Club. David has several hobbies and is currently studying bladesmithing and leather work.

BUTTON GWINNETT



SECOND YEAR BEEKEEPING – *You've gotten your colonies through the first year, now what? This informative talk will help you prepare for year two.*

PAUL BERRY is a Master Beekeeper from Box Springs, Georgia. With over 60 hives, he can't decide if he is a hobby beekeeper or a sideline. Although honey is a great reward, Paul's passion is learning about these fascinating creatures and teaching what he has learned to new beekeepers.

ABRAHAM
BALDWIN



SESSION A: TIPS AND TRICKS FOR EASY HIVE INSPECTIONS
SESSION B: HOW DO DO A MITE COUNT

BOBBY CHAISSON is a Georgia Master Beekeeper who has more than 14 years experience with bees all over the southeast as part of his work for Georgia Bee Removal. He will share tips and tricks he has picked up over the years from many other beekeepers.

OUTDOORS*

SATURDAY BREAKOUT SESSIONS C & D *(Sessions Repeat)*

LOCATION



NEW INVENTIONS FOR SMALL HIVE BEETLE CONTROL – *Learn about the latest research from the University of Georgia regarding small hive beetle control.*

DR. LEWIS BARTLETT, PH.D., is an infectious disease biologist, entomologist, and evolutionary ecologist at the University of Georgia's Center for the Ecology of Infectious Diseases. He uses field studies, laboratory experiments, and computer simulations to understand how changes in beekeeping are affecting bee diseases in both the short and long term.

LYMAN HALL



THE LIFE & TIMES OF A COMMERCIAL BEEKEEPER – *If you're interested in taking the plunge and making your operation commercial, this talk will inform you about the steps and pitfalls you might find along the way.*

VICTOR HALBGEWACHS is a second generation beekeeper growing up in a 5,000 beehive operation of his father's in Nebraska. Victor went on his own in 1983 living in North Carolina, Georgia and Florida, finally settling down in Cartersville, Georgia. Today, he and two of his sons operate a commercial bee business involved in nucs, almond and blueberry pollination and honey production.

JAMES OGLETHORPE



EVERY BEEHIVE TELLS A STORY – *Inspecting a beehive is like a choose-your-own-adventure story. Learn clues to look for and the possible choices each might indicate as you inspect your beehive.*

LINDA TILLMAN has been keeping bees since April 2006. She is a Master Beekeeper, past president of the GBA, and was named GBA's Beekeeper of the Year in 2020. During the pandemic, Linda, in her role as chair of the MABA Hive Inspection program, presented hive inspections on Zoom to allow new beekeepers to continue to learn about going into a hive, despite the fear of COVID. She loves teaching and connecting with new beekeepers.

BUTTON GWINNETT



SESSION C: TIPS AND TRICKS FOR EASY HIVE INSPECTIONS
SESSION D: HOW DO DO A MITE COUNT

BOBBY CHAISSON is a Georgia Master Beekeeper who has more than 14 years experience with bees all over the southeast as part of his work for Georgia Bee Removal. He will share tips and tricks he has picked up over the years from many other beekeepers.

OUTDOORS*

* These breakouts will be hands-on sessions outdoors in the apiary. You must bring your own protective gear. Veils are mandatory